

# Coping

\* Custom sizes available

Sheets Used:

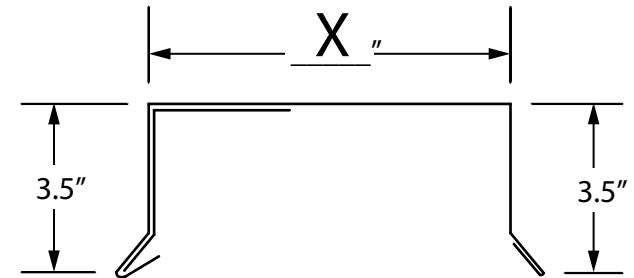
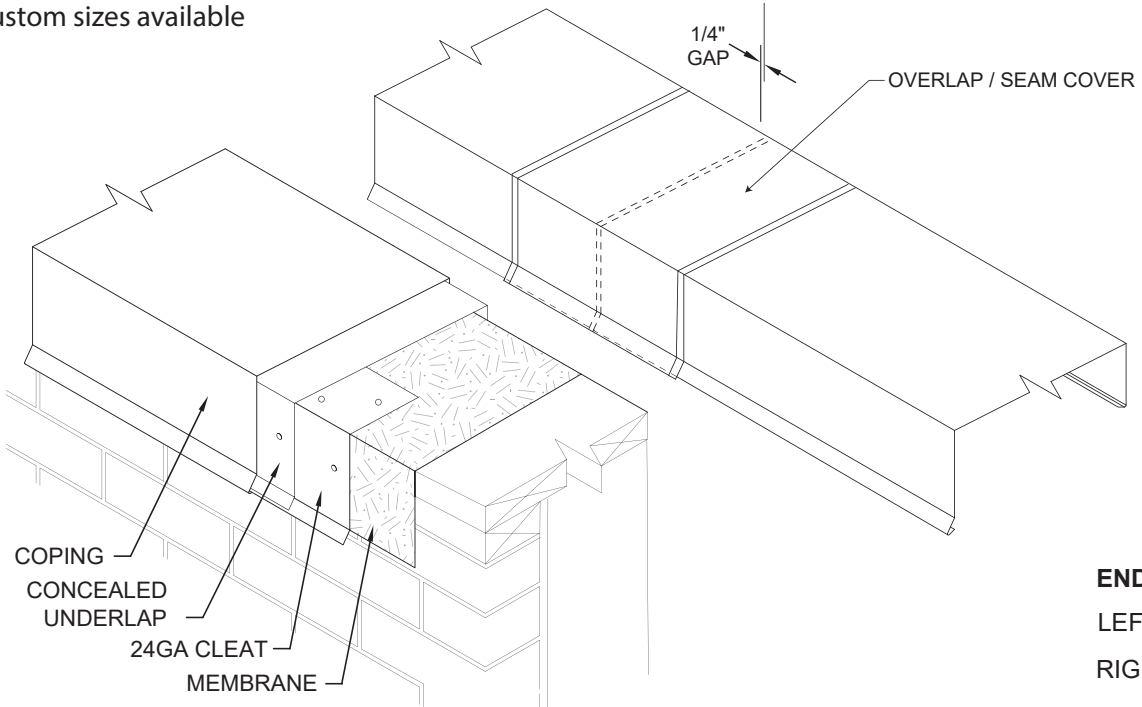

**END CAPS:** ( LOOSE  OR ASSEMBLED  )

LEFT QTY: \_\_\_\_\_

RIGHT QTY: \_\_\_\_\_

COPING: \_\_\_\_\_ LF

CLEAT: \_\_\_\_\_ LF

**MITERS:**

INSIDE QTY: \_\_\_\_\_

OUTSIDE QTY: \_\_\_\_\_

OVERLAP: \_\_\_\_\_ PCS

UNDERLAP: \_\_\_\_\_ PCS

**MATERIAL**

- Aluminum Kynar .032 or \_\_\_\_\_  Color \_\_\_\_\_
- Galvanized G-90 24 Gauge
- Stainless Steel Type 304
- Painted Steel Kynar 24/26Gauge  Color \_\_\_\_\_
- Copper 16/20 oz or \_\_\_\_\_
- Patina 3000 16/20 oz \_\_\_\_\_
- Brown Copper 16/20 oz \_\_\_\_\_  Light  Dark
- SMS Stainless 24G \_\_\_\_\_
- Zinc \_\_\_\_\_

Due Date:

Job #:

X	LF	Cleat	Overlap	Underlap

**CUSTOMER APPROVAL**  
 Approved for Fabrication \_\_\_\_\_  
Authorized Customer Signature

Job Address: \_\_\_\_\_  
 PO #: \_\_\_\_\_ Order taken by: \_\_\_\_\_  
 Date Ordered: \_\_\_\_\_ Phone #: \_\_\_\_\_



4940 W Grand ave. Phone: 773-227-6200  
 Chicago IL 60639 Fax: 773-227-1700  
 e-mail: info@chicagometalsupply.com

Completed By:

Estimate #: